

## 25 Ilinga Avenue Balhannah SA

3 2 3

There's no better debut buy or retirement plan than a tightly held Balhannah pocket, a modern colonial abode, and its immaculate 840sqm garden gift?

Bringing all-class appeal and a paved, private driveway paralleled by a lush garden rise, this upgraded family home will attract any buyer who relishes a glorious garden view or two.

Warm timbers, stained glass, and a tiled foyer create an inviting welcome to the carpeted formal bay windowed lounge, while newly laid timber floors - blanketing the open plan family zone, perfect for indoor entertaining - follow suit.

**Type** : House  
**Price** : \$755,000  
**Land Size** : 840 sqm  
**View** : <https://www.adcock.com.au/7322219>



**Andrew Adcock**  
 08 8388 4777



**Nikki Seppelt**  
 08 8388 4777

[For full version visit the website](#)



RWT

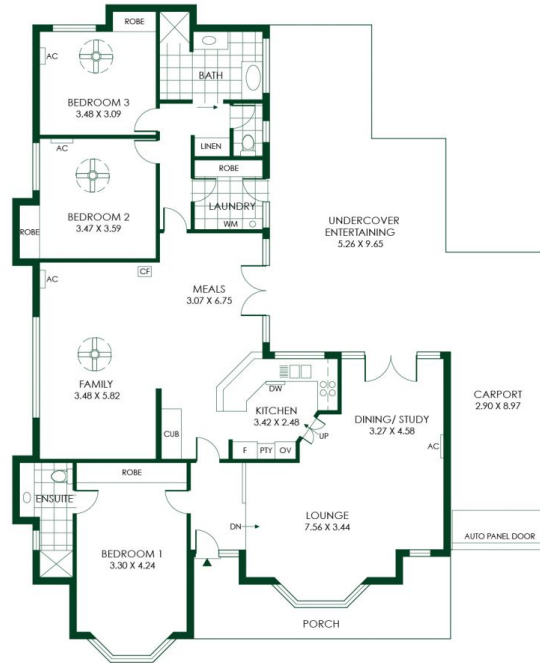
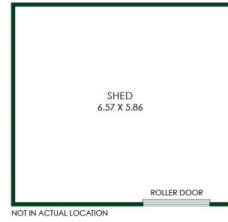

283m<sup>2</sup>

TOTAL

166m<sup>2</sup>

Living

47m<sup>2</sup>

Shed

26m<sup>2</sup>

Carport

44m<sup>2</sup>

Undercover  
Entertaining





